



RANCH HOUSE DOORS

— *Redefining the Entrance™* —



SEMI-CUSTOM COLLECTION



Model: Oahu **Species:** Semi-PG-1, Smooth
Window: RHD-SQ-1 RHD#431



Model: San Clemente **Species:** Semi-PG-1, Smooth **Window:** RHD-AR-1 RHD#872



Model: Sonesta **Species:** Semi-PG-1, V-Groove **Window:** RHD-SQ-7 RHD#9661

SEMI-CUSTOM COLLECTION

The Semi-Custom Collection has been inspired by Rail and Stile doors that been modified to compliment Spanish & Cape Cod Collections at a more competitive price.

IT'S AS EASY AS...



CHOOSE YOUR DOOR STYLE

Clean lines and natural character come together in thoughtfully crafted designs.

CHOOSE YOUR WOOD TYPE

Choose durable woods like cedar for a warm, natural look.

CHOOSE YOUR OPTIONS

Personalize with your choice of black hardware and streamlined window options.

CHOOSE YOUR DOOR STYLE

Scan For More Options



Model: Laguna Species: Semi-PG-1, Smooth Window: RHD-SQ-2 RHD#3084

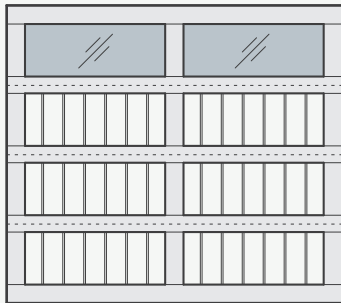

Redondo

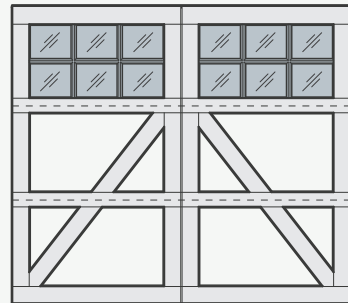

Oahu

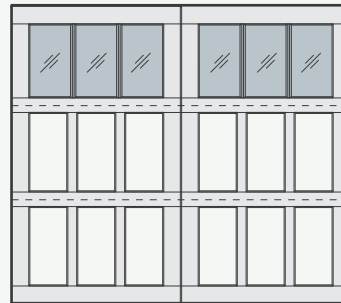

San Clemente

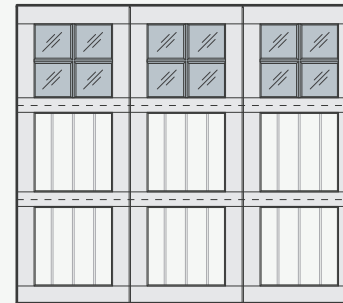

Sonesta

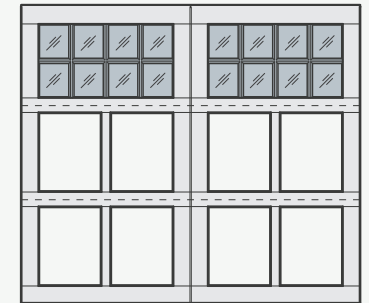

Laguna

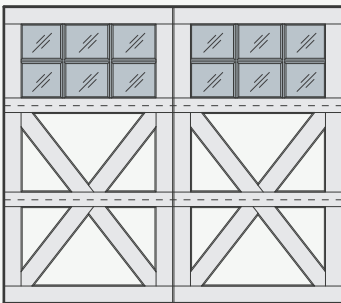

Sands

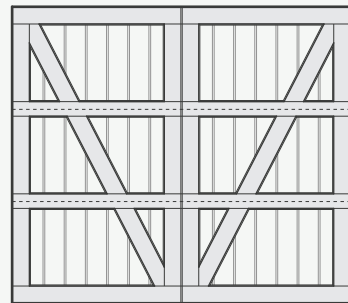

Cardiff

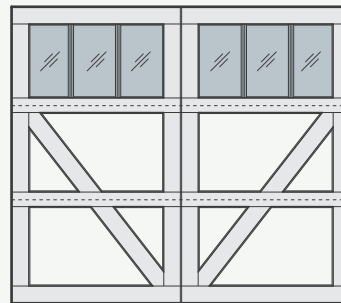

Myrtle

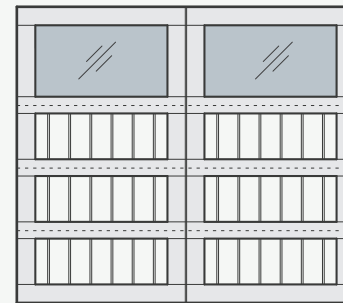

Marbella

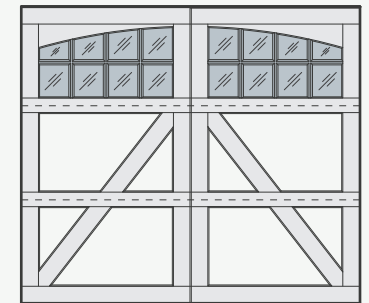

Honolulu



Model: Manzanita Species: Semi-PG-3, V-Groove RHD#522

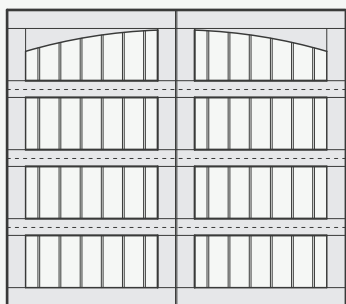

Manzanita



Huntington

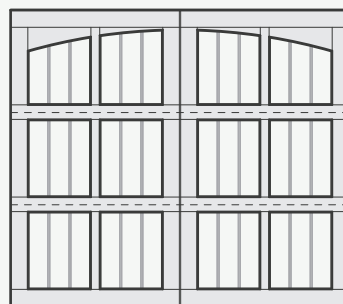

Versilla

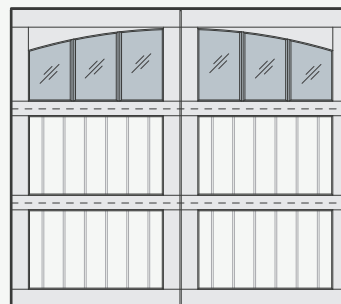

Costa Azul

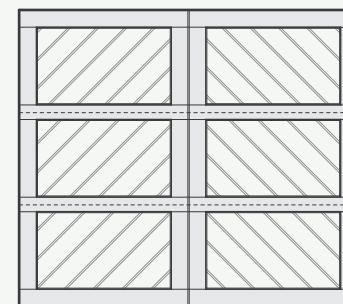

Hanauma

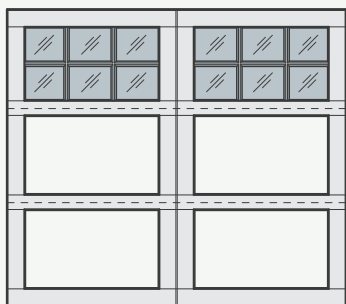

Coronado

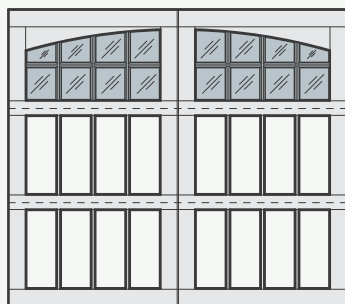

Monterey

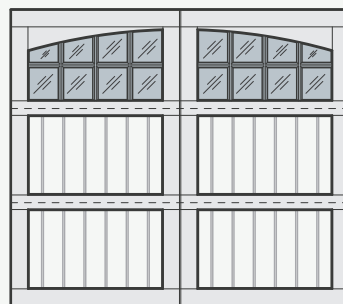

Portofino

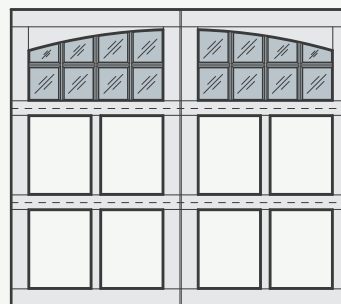

La Jolla

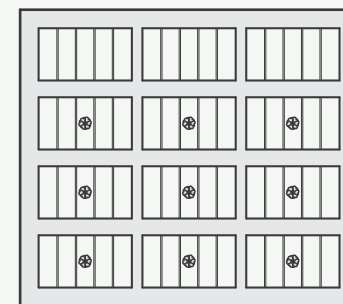

Chacala

CHOOSE YOUR WOOD TYPE

2



Model: Huntington **Wood Type:** Semi-PG-1, Smooth **Window:** RHD-SQ-1 RHD#420

CHOOSING BETWEEN STAIN GRADE AND PAINT GRADE DOORS

At Ranch House Doors, we build semi-custom garage doors with premium craftsmanship and timeless style. When choosing your door, one of the key decisions is **Stain Grade vs. Paint Grade**—each offers its own unique benefits depending on your design goals.

PAINT GRADE WOOD OPTIONS

Designed for a Smooth, Custom Painted Finish

Paint Grade doors use strong, economical wood components designed to be painted. These doors are ideal for matching your home's color scheme and provide a clean, uniform surface.

- **Frame Material:** Finger-jointed (FJ) Hemfir for strength and stability
- **Panels:** Raised or recessed panel options
- **Perfect For:** Homeowners who want design flexibility with custom paint colors



Semi PG-1
Finger -Jointed (FJ) Hemfir Frame, 6mm Meranti Panel Ply
V-Groove or Smooth Panel



Semi PG-2
Finger - Jointed (FJ) Hemfir Frame, Texture Smooth
Extra 1/2" Raised Panel



Model: Chacala **Species:** Semi-PG-5, Hemfir Frame, Incense T&G V-Groove **RHD#504**

STAIN GRADE WOOD OPTIONS

Crafted to Showcase Natural Wood Beauty

Stain Grade doors are built with high-quality, visually appealing wood species that are meant to be stained—not painted. These doors highlight the natural grain, color, and texture of the wood, offering a warm and luxurious look.

- **Wood Options:** Clear Hemfir, Cedar, or Mahogany
- **Panels:** Edge-glued solid wood or marine-grade Meranti plywood
- **Styles:** Raised or recessed panel
- **Perfect For:** Homeowners who want to enhance their curb appeal with the natural character of real wood



Semi SG-3
Solid Hemfir Frame, 6mm Birch Panel Ply
V-Groove or Smooth Panel



Semi PG-4
Solid Western Red Cedar Frame
T&G V-Groove Panel

Semi SG
Non Standard, Special Request. Example: A. Redwood B. African Mahogany

All doors that exceed 7'0" will be four sections. This includes but is not limited to 7'6" and 8'0" high doors.

For more information on how many sections your door will be, please speak to your salesperson and request a drawing to help you achieve your unique design.

CHOOSE YOUR OPTIONS

3

A WOOD TEXTURES

No Charge



Smooth

B INTERIOR EDGE OPTIONS



Coped

HARDWARE UPGRADES



Powder Coated Hardware

- Black or White Powder Coat Available
- Custom Colors Available

Noise Reduction Package

- Quiet Hinges *(Cannot be powder coated)*



SEMI-CUSTOM DOOR SPECIFICATIONS

Standard heights include 6'6", 7'0", 7'6", 8'0" - other heights can be custom built upon request.

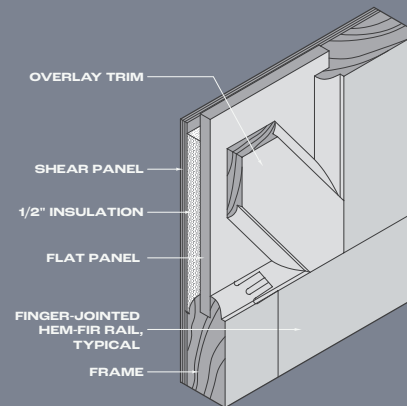

SEMI PG-1

- 1 3/8" Deep Plow rail and stile construction
- Finger jointed hem for rails and stiles
Clear rails optional
- Exterior grade birch panels with or without v-grooves
- Double center stiles with v-groove
- Tru - Divided Lites
(Thru and Thru arch optional)
(Window caulking optional)
- 1/2" polystyrene insulation
- Exterior paint grade luan back
- Primed
- Pre drilled and pilot drilled

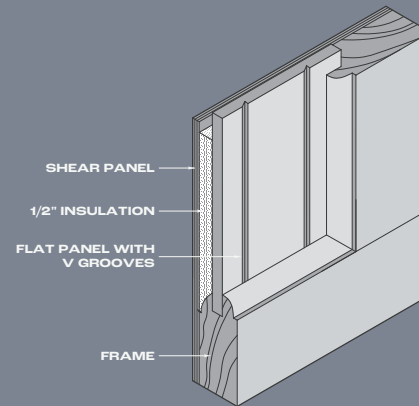

SEMI SG-3

- 1 3/8" Deep Plow rail and stile construction
- Clear hem fir rails and stiles
- Exterior grade birch panels with or without v-grooves
- Double center stiles with v-groove
- Tru - Divided Lites
(Thru and Thru arch optional)
(Window caulking optional)
- 1/2" polystyrene insulation
- Exterior stain grade luan back
- Pre drilled and pilot drilled

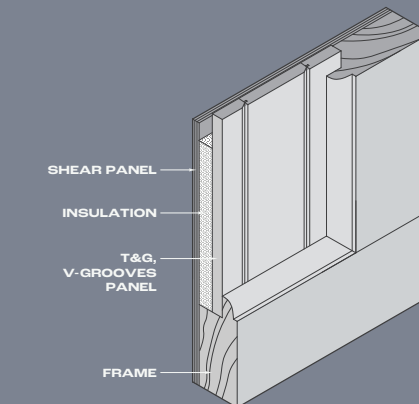

SEMI SG-4

- 1 3/8" Deep Plow rail and stile construction
- Finger jointed hem for rails and stiles
Clear rails optional
- Exterior grade birch panels with or without v-grooves
- Double center stiles with v-groove
- Tru - Divided Lites
(Thru and Thru arch optional)
(Window caulking optional)
- 1/2" polystyrene insulation
- Exterior paint grade luan back
- Primed
- Pre drilled and pilot drilled

WINDOW OPTIONS

Note: These tops are drawn for 8-0 x 7-0 doors.

The mullions are 1 3/4" and tru divide lites, unless noted otherwise.

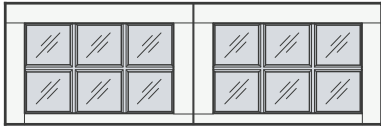

RHD-SQ-1



RHD-SQ-2

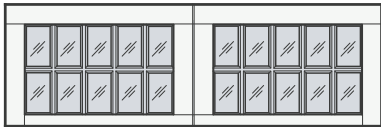

RHD-SQ-3

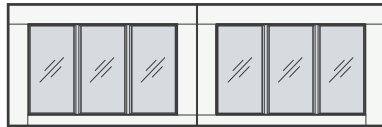

RHD-SQ-4

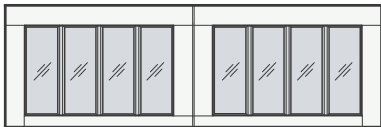

RHD-SQ-5



RHD-SQ-6

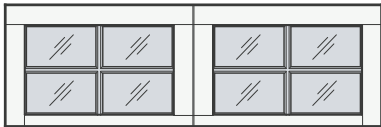

RHD-SQ-7

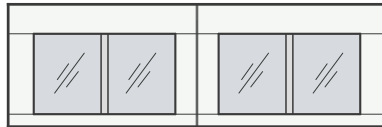

RHD-SQ-17

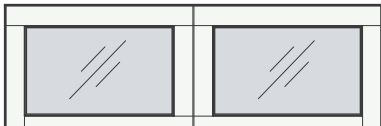

RHD-SQ-15

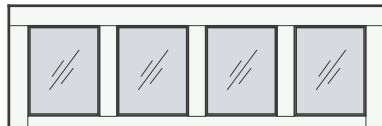

RHD-SQ-16

Arch Options

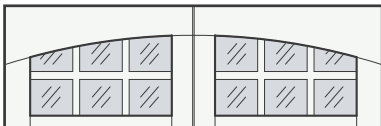

RHD-AR-1

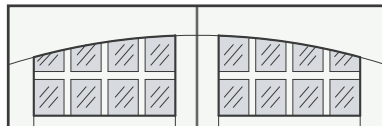

RHD-AR-2

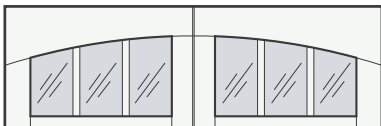

RHD-AR-4

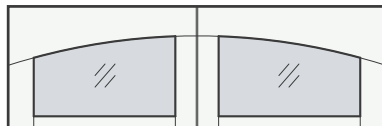

RHD-AR-15

*Windows are Tru Divided unless otherwise noted. *Wood windows are Tru Divided.

*Specialty glass available upon request. Arch (AR) can be added to any Square (SQ) design.

GLASS TYPES



Scan QR code for more options. Clear / Upgrades are available with various types of glass. All glass is Annealed, Tempering is an optional upgrade. Insulated glass available upon request. Copyright Notice: All materials shown in this brochure are copyrighted and may not be duplicated in any form. ©2026 Ranch House Doors.



Clear
Standard

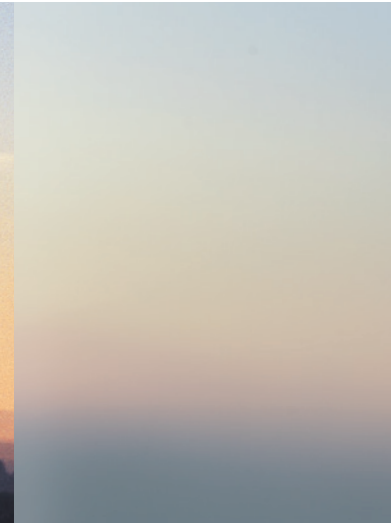

Acid Etch/Frosted
w/Durashield

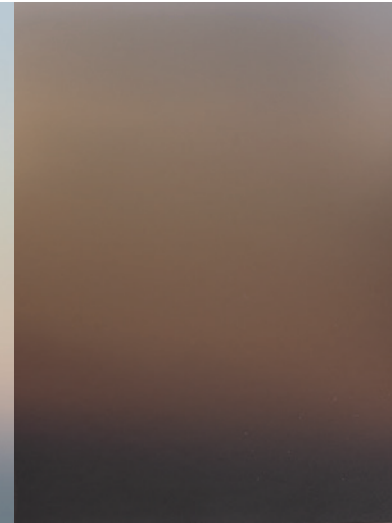

Bronze

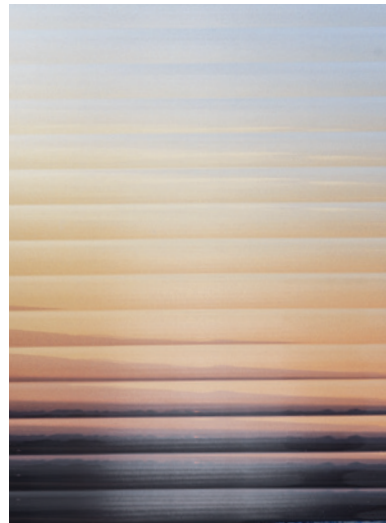

Reeded Glass
1/2" Flutes



Dark Gray

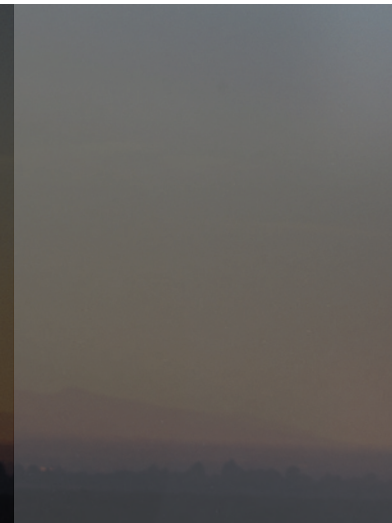

Dark Gray/Tinted
w/Sand Blast Durashield

BUILT ON LEGACY



RANCH HOUSE DOORS

— *Redefining the Entrance* —



PHONE

951.278.2884

ADDRESS

1527 Pomona Rd,
Corona, CA 92878



Scan the QR code for
RHD warranty/stain information.

In a small La Mirada garage more than two decades ago, our father, Mike Neal, built his first custom wood door. The garage was alive with the sounds of roaring machines, and the air was thick with sawdust—a symbol of hard work and creativity.

Dad often said, “I love the smell of sawdust in the morning.” That passion turned what began as a “little experiment” into Ranch House Doors—one of the nation’s premier door manufacturers.

Today, we carry on Dad’s legacy, creating handcrafted garage doors, entry doors, gates, and more for homes across the country. Our skilled design team is here to turn your ideas into reality, blending timeless craftsmanship with your unique style.

For us, every door is more than just a product; it’s an opportunity to make your home warm, functional, and truly exceptional. Because like Dad always said, “If you can think it, we can build it.”



Only garage doors featuring the official **Ranch House Doors serial number plate of authenticity** are genuine Ranch House Doors products. This serial number plate represents our commitment to craftsmanship, premium materials, and enduring quality. Doors without it are not made or authorized by Ranch House Doors and do not carry our warranty or brand guarantee. **Look for the serial number plate—it’s the mark of true craftsmanship.**